

RIVOLINO-IV

Semi automatic Layup and automatic fixation machine for inner layer and prepreg.

RivetBonding Technology.



The specific features of the RIVOLINO-IV technology

- Fixation technology Riveting and RivetBonding
- Lowest tolerances for high layer count ML
- Panel thickness up to 6.0mm
- Only 6-8mm boarder necessary for riveting
- Very fast change over to various panel size
- Lay up on templates with 2 registration pins
- Hydraulic flattening device for rivets
- Positions of rivets programmable
- Panel lift system for fast panel changing
- Servo driven transport system
- Upgrade with Layup2 modules to pinless layup system including 4 CCD-optical registration and alignment.
- Panel size up to 650 x 635



Swiss Quality



PRINTPROCESS AG

Printprocess AG Sumpfstrasse 13 CH-6300 Zug Switzerland
Telefon +41 41 7498080 Fax +41 41 7498090 info@printprocess.com www.printprocess.com

Specification RIVOLINO-IV	
Process	Riveting and RivetBonding of inner layer and prepreg
Panel size	min. 205 x 305 mm (8" x 7,74") max. 650 x 635 mm (25.6" x 25")
Panel thickness	standard 0.3 (0,0118") up to 6.0 mm (0,236")
Production Capacity	up to 80 multilayer per hour
Compressed air	min. 6 bar
Electrical connection	400V, 3 phase, 50Hz, max. 10A
Dimensions	1'780 x 1'200 x 1'415 mm
Weight	380 kg

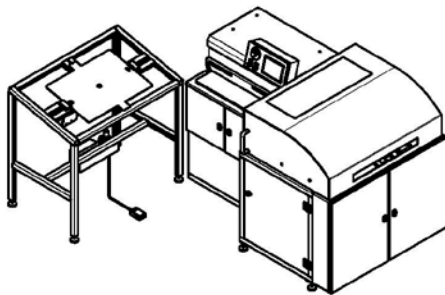
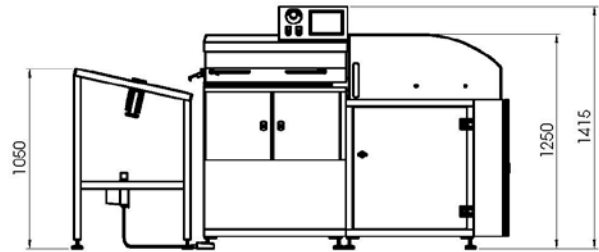
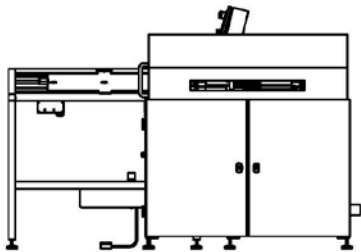

RILU 04 mit Legetisch

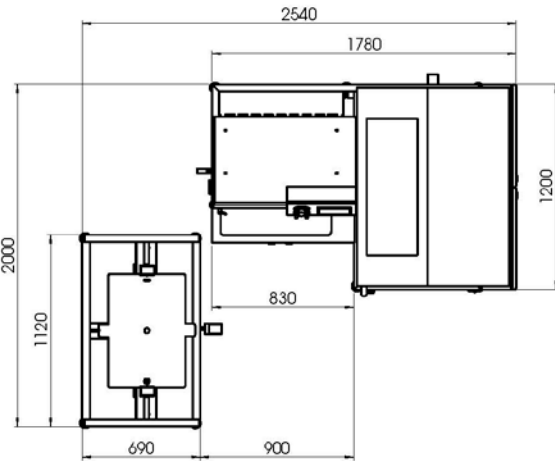

Technical characteristics described in this data sheet are for information only. They are not contractual and may change without prior notice.